



WATERX  
TECHNOLOGIES, Inc.  
7925 Silverton Ave #510  
San Diego CA 92126

Email: [avi@NoLix.AI](mailto:avi@NoLix.AI)  
[www.nolix.ai](http://www.nolix.ai)

→ **Protect The Environment**

→ **Protect Your Property**

→ **Reduce Costs**

→ **No Install required**

→ **Battery operated**

→ **Advance Patented AI/ML**

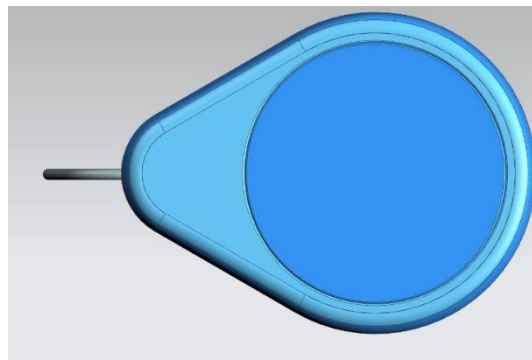

Over 20% of toilets within the United States suffer from unnoticed regular leaks. Current smart home meters fail to identify these leaking toilets as a problem. The NoLix.AI patented ML-Based Toilet Leak Detector is designed to address this issue directly. This innovative device, which floats within the toilet's flush tank, gathers and reports data on water usage and sends leak alerts. Utilizing an internal accelerometer-based algorithm, it precisely tracks the fluctuations in the tank's water level.

## HIGHLIGHTS

- Seamlessly integrates with the NoLix app for easy device setup and continuous leak monitoring.
- Detects a wide range of leaks, from small drips to large breaches
- Sends consistent updates on water level and battery status via regular status messages.
- User-friendly: No- Install required - Simply deploy the device into the tank for instant activation.
- Offered in various versions to support different communication protocols.
- Sends alerts for detected water leaks and low battery warnings.
- Compatible with every kind of flush tanks
- Housed in an IP65-rated waterproof enclosure, ensuring total protection from dust, oil, and water.

## PRODUCT VARIANTS:

WaterWF  
Toilet Leak



WaterZ Toilet  
Leak Detector



Available in 2023

WaterZG Toilet  
Leak Detector



Available in 2023

WaterLoRa Toilet  
Leak Detector



Available in 2023



# Technical Specifications

WATERX  
TECHNOLOGIES, Inc.  
7925 Silverton Ave #510  
San Diego CA 92126

Email: [avi@nolix.ai](mailto:avi@nolix.ai)  
[www.NoLix.AI](http://www.NoLix.AI)



- Outer Dimensions: 1150 mm x 90 mm x 30mm
- Weight: 75g
- Battery life: 2 years
- Battery Type: CR123
- Waterproof enclosure
- Transmitter operating environment: 10 to 50 °C
- Market: Worldwide
- Regulatory compliance: FCC



*The range and performance of any wireless product depends on the structure and environment in which it operates. Continual enhancements to our products may cause specifications to change without notice.*

*Patented technology*

*WaterX Technologies, Inc supports recycling and reuse whenever possible. Please recycle these parts using a certified electronics*